



VISATEC
PART OF ISEC

VT 25 FL

camera system brochure



VT 25 FL inspection camera

Extremely compact, watertight color camera with integrated lighting, focus and an outer diameter of 25 mm

Features

- ▶ Small and robust design in stainless steel
- ▶ Outer diameter of 25 mm
- ▶ Radiation resistant
- ▶ PAL/NTSC
- ▶ Integrated LED lighting
- ▶ Water tight up to 50 m

Applications

- ▶ Pipe inspection
- ▶ Underwater inspection
- ▶ Remote operated manipulators
- ▶ Retrieval of foreign objects
- ▶ Hard to reach areas
- ▶ Industry
- ▶ Sewer inspections
- ▶ Nuclear facilities

Technical specifications – VT 25 FL camera system

This document is for general information only,
please consult the system manual for detailed specifications

Housing	stainless steel
Image sensor / number of effective pixels	1/3" CMOS
Horizontal resolution	600 TVL
Signal system	PAL/NTSC
Minimum illumination	0.001 lx
Optical zoom	n/a
Digital zoom	n/a
Focus	manual (motorized)
FOV	---
Minimum object distance	---
Video output	CVBS
Range - PAN	n/a
Range - TILT	n/a
Lighting	12x LED
Luminous flux	~ 108 lm
Dimension (ø x L)	25x78 mm
Weight	--- kg
Operating temperature	---
Water tight / water depth	5 bar / 50 m
Radiation tolerant 1 / 2	5,500 rad/h (55 Gy/h)* / 2,100 rad/h (21 Gy/h)
Total dose 1 / 2	30,000 rad (300 Gy) / 80,800 rad (808 Gy)
Optionals	---
Features	---

* many ray pixels

* unit in mm

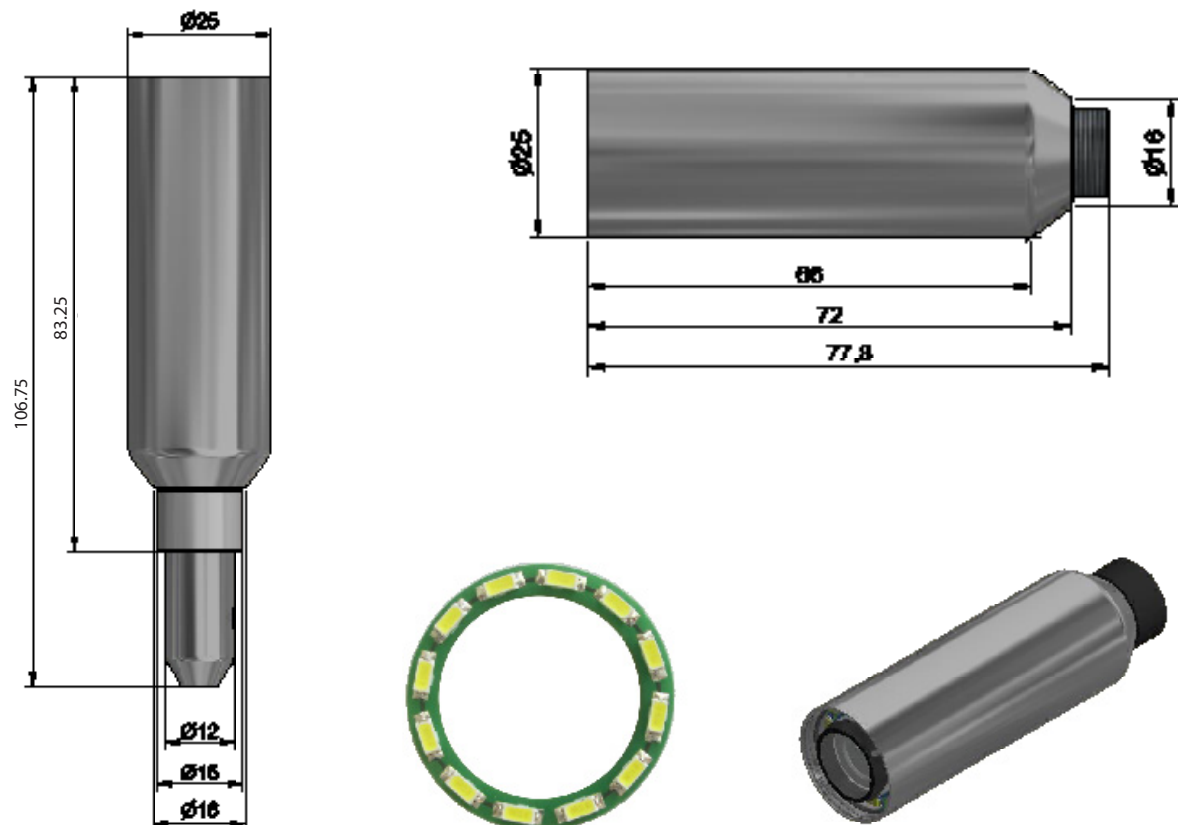

Setup

Possible combinations

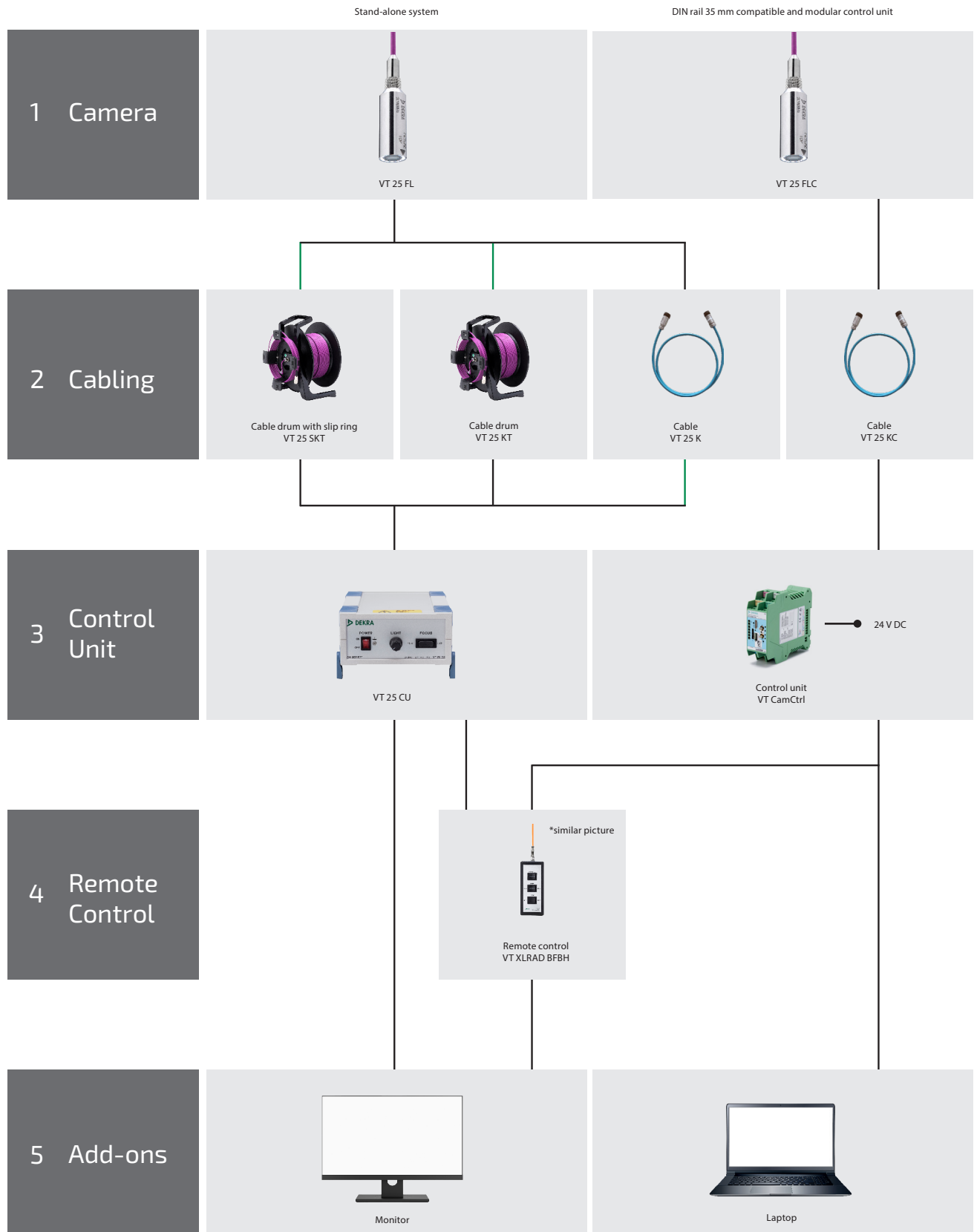

Accessories



VT 29 carbon poles - 29 or 42 mm diameter
Connectable carbon poles for deployment of cameras and tools - standard lengths are 1 and 2 m

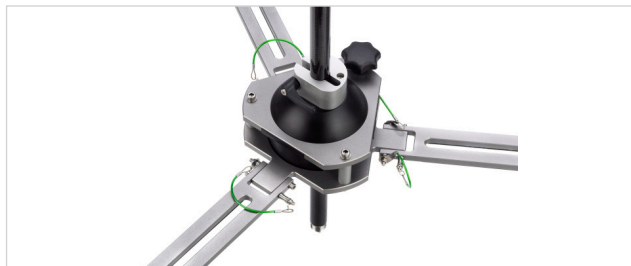

Manhole holder
Versatile positioner for 29 or 42 mm carbon poles

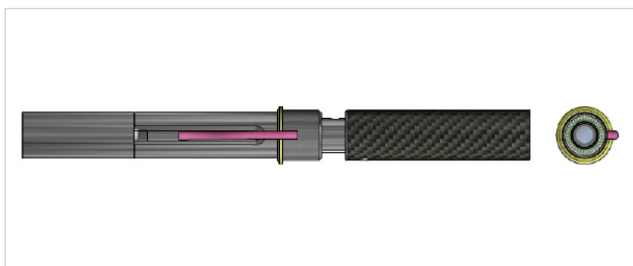

VT 25 FL holder
Carbon pole with quick-release coupling to adapt the camera



VT GH Vario tool holder
Variable railing bracket with stainless steel adapter for connecting the camera to 29 or 42 mm diameter carbon poles



Prismatic attachment
To rotate the field of view by 90°. Application e.g. to have the camera outside the radiation area

ISEC Visatec GmbH
Gewerbepark 7
87477 Sulzberg
Telephone +49 8376 9215-0
info@visatec.de
visatec.de